

Assembly, Operating & Maintenance Instructions

mondo

Attention: Please remove all items from the carton, and verify all pieces before assembly.

MONDO JAVA HIGH/MID BACK 3 LEVER CHAIR

STEP 1.

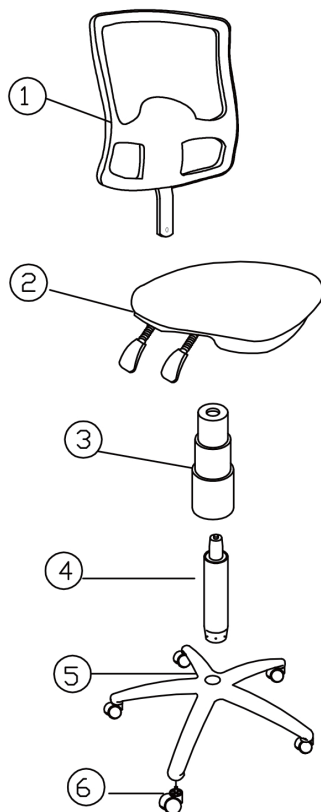

STEP 2.

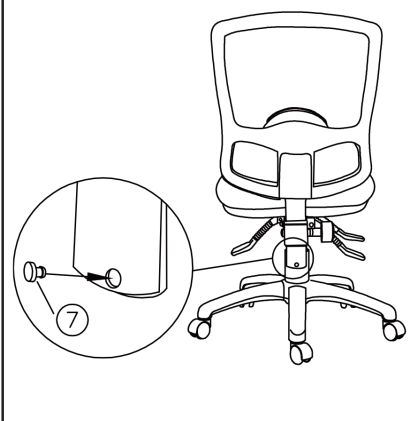

STEP 3.

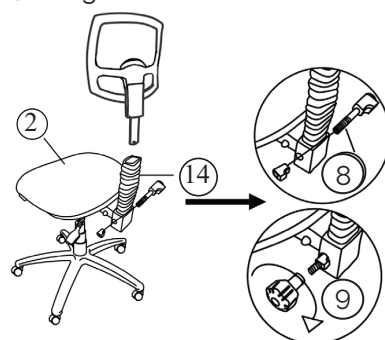

STEP 4



ARMS:

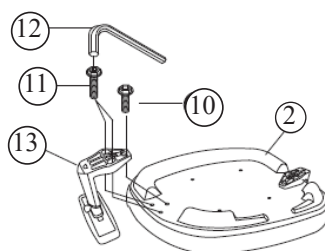

* Arm assembly instructions are for Java chairs purchased with arms only.

Parts List

| KEY | QTY | DESCRIPTION |
|-----|-----|------------------|
| 1 | 1 | Mesh Back |
| 2 | 1 | Seat |
| 3 | 1 | Gas Lift bellows |
| 4 | 1 | Gas Lift |
| 5 | 1 | Chair Base |
| 6 | 1 | Castors |
| 7 | 5 | Back Bar Bung |
| 8 | 1 | Tension Pin |
| 9 | 1 | Adjustment Knob |
| 10* | 2 | Short Arm Screws |
| 11* | 4 | Long Arms Screws |
| 12* | 1 | Allen Wrench |
| 13* | 1 | Arms |
| 14 | 1 | Back Bar Cover |

*Optional arm hardware only for Java chairs purchased with arms

Care & Maintenance

FABRIC/MESH UPHOLSTERY CARE

- Wipe with a clean cloth dampened with a mild upholstery detergent solution.
- A soft bristle brush may be used to remove ingrained soil.
- Spot clean as above.
- Treat spills and stains as soon as possible.
- Persistent stains may require treatment by a professional cleaner.
- May be cleaned with dry powder cleaners.
- Allow to dry thoroughly before reuse.

GENERAL CARE

- To maintain the appearance of non-upholstered parts wipe the surface with a clean cloth dampened with a mild detergent solution.
- Do not remove any parts for separate cleaning.
- Do not saturate the fabric or interior with water or other cleaning liquids.
- Do not shampoo clean.
- Do not clean with hot water extraction machine.
- Do not clean with onsite drycleaning machine.
- Protect from direct sunlight, heat and weather.

Upholstery & Foam Specs*

FOAM

Flame Resistant: Ca117 Section A Part I & Section D Part II

UPHOLSTERY: FABRIC

Flame Resistance: Ca117 Section E Class I

*This applies only to standard Mondo stock. Any customer specified upholstery may not meet these specifications.

Preventative Maintenance & Warning!

- Use this product only for seating one person at a time.
- Do not use this chair as a step stool/ladder.
- Do not sit on any part of the chair except the seat.
- Do not use this chair on uneven floor surfaces.
- Do not interfere with the operating of the gas lift.
- Do not use chair unless all bolts, screws and knobs are tight.
- At least every six months check all bolts, screws and knobs to ensure they are tight.
- If any parts are missing, broken, damaged or worn do not use the product until repairs are made using factory authorised parts.
- Dispose of packaging properly.
- Plastic bag is not a toy.
- Do not use plastic bag as a head covering as it may cause suffocation.
- Failure to follow these warnings could result in serious injury.